

Specifications	Pro50
Nominal Size	5 1/4"
RMS Power Handling	125 watts
Peak Power Handling	250 watts
Nominal Impedance	3 ohms
Frequency Response	60Hz-22kHz (+/- 3dB)
Sensitivity	90dB (1watt @ 1meter)

#	Description	Quantity
1	Pro50 Woofer	2
2	Type-M2 1" Alloy Dome Tweeter	2
3	Pro50 Woofer Crossover	2
4	Pro50 Tweeter Crossover	2
5	Tweeter Grille	2
6	Tweeter Axis-Mount	2
7	Tweeter Flush-Mount	2
8	Tweeter Angle-Mount (top)	2
9	Tweeter Angle-Mount (bottom)	2
10	Adapter Plate	2
11	Woofer Gasket	2
not shown	Woofer Hardware Package	1
12	Boston Hex Tool	1
13	Woofer Grille	2
14	Small Gold Terminal	2
15	Large Gold Terminal	2
16	Crossover Bridge	2
not shown	Crossover Hardware Pack	2
17	Axis-Mount Screws	4
18	Spring Clips	4
19	Compact Gold Terminals	4
20	Axis-Mount Stand-Off	2
21	3/8" Pan Head Screw	2
22	1" Pan Head Screw	2
not shown	1/2" Pan Head Screw	2
23	1 1/8" Socket Button Head Screw	16
24	1 1/2" Hex Nut	2
25	1/2" Self-Tapping Screw	4
26	1" Self-Tapping Screw	4
27	3/32" Hex Bit	1

High Performance 5 1/4-inch Component Speaker System



Boston Acoustics, Inc. 300 Jubilee Drive, Peabody, MA 01960 USA T: 978.538.5000 F: 978.538.5100 W: bostonacoustics.com
 Boston, Boston Acoustics, and the Boston Acoustics logo are registered trademarks of Boston Acoustics, Inc.
 Specifications are subject to change without notice.
 © 2004 Boston Acoustics, Inc. All rights reserved. Covered by patents issued and/or pending.

042-002120-0



Axis-Mount

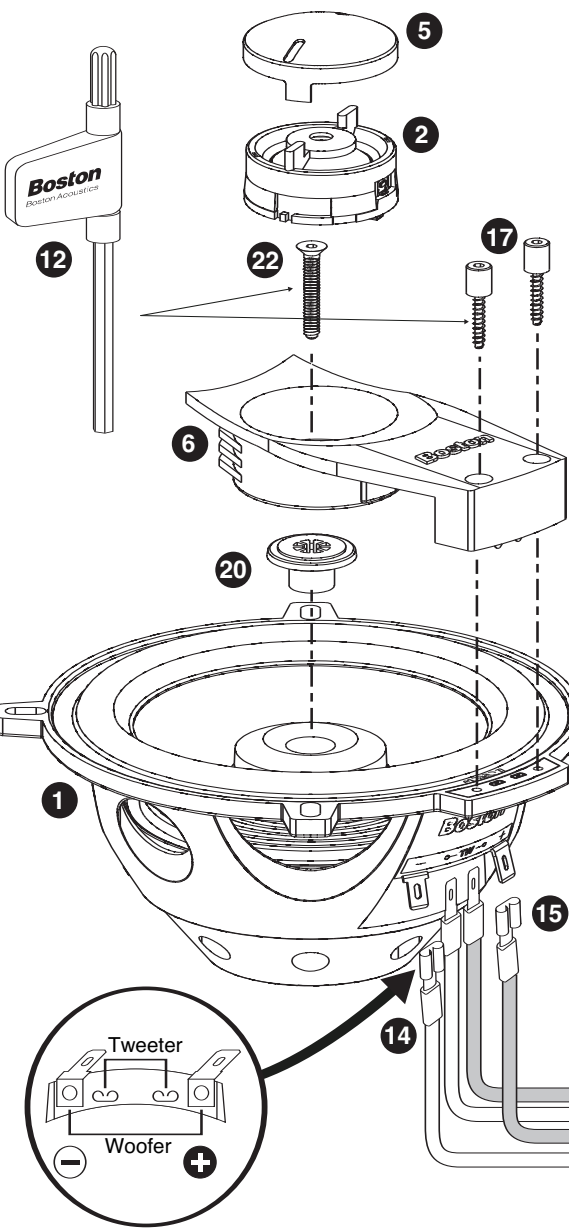

Flush-Mount

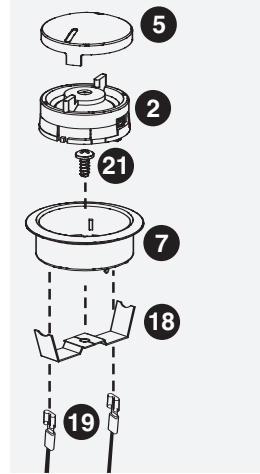

Angle-Mount

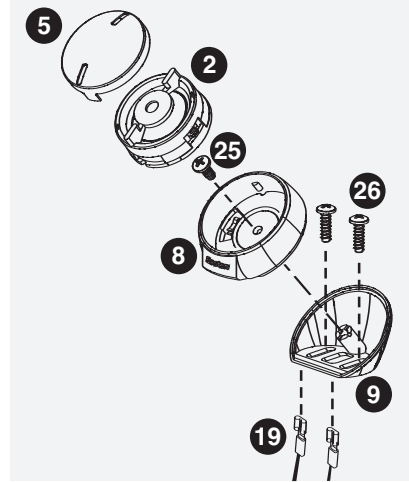

Tweeter Installation

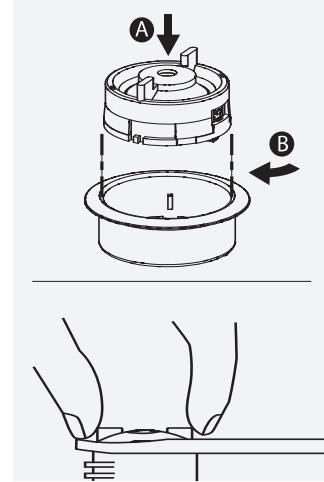

Tweeter Attenuation

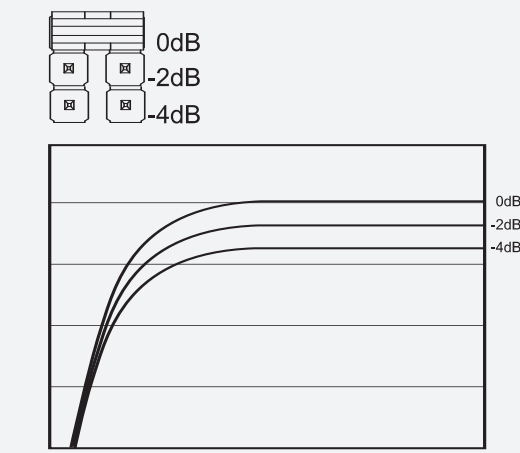

Axis / Component Configuration

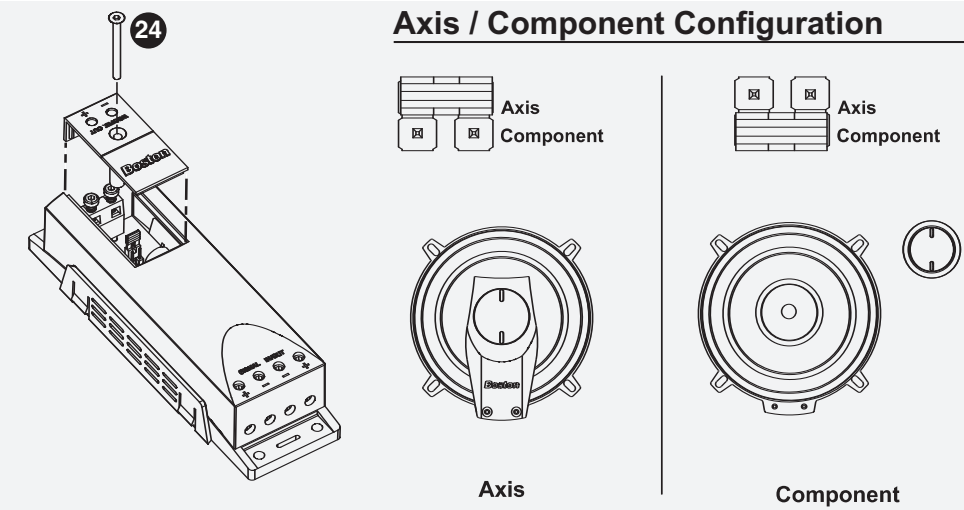

5/4-inch (135mm) Adapter

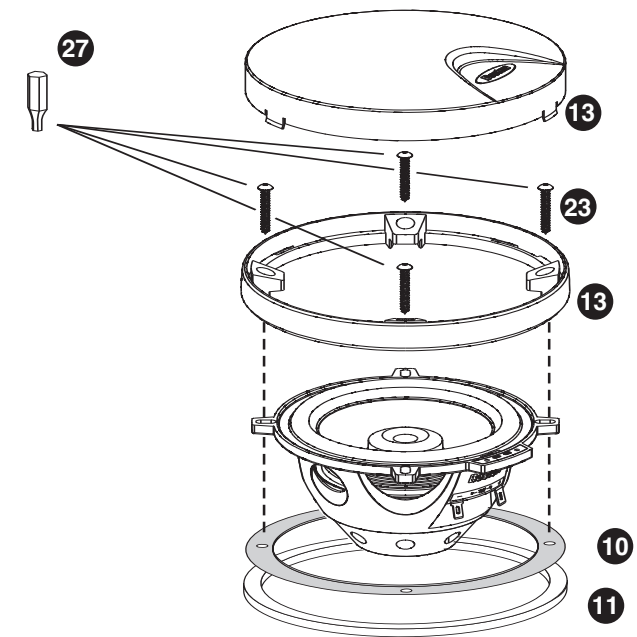

Key on Back Page

Signal Bridge

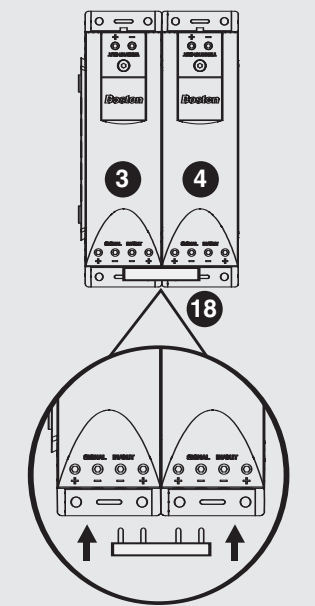

Crossover - Single Input

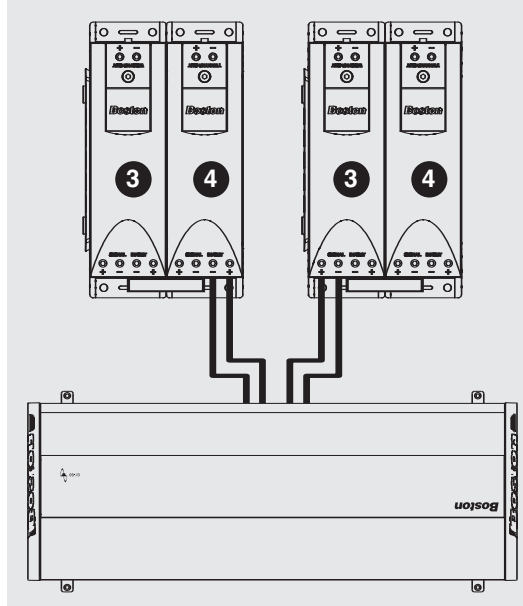

Crossover - Bi-Wire / Bi-Amp

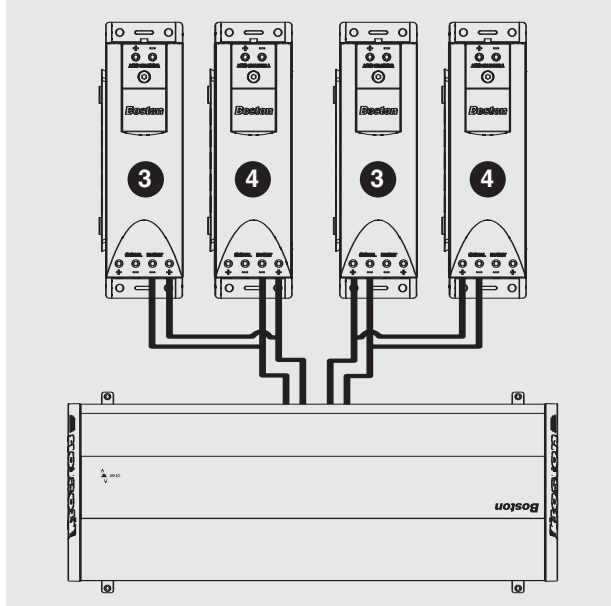

Crossover - Daisy Chain

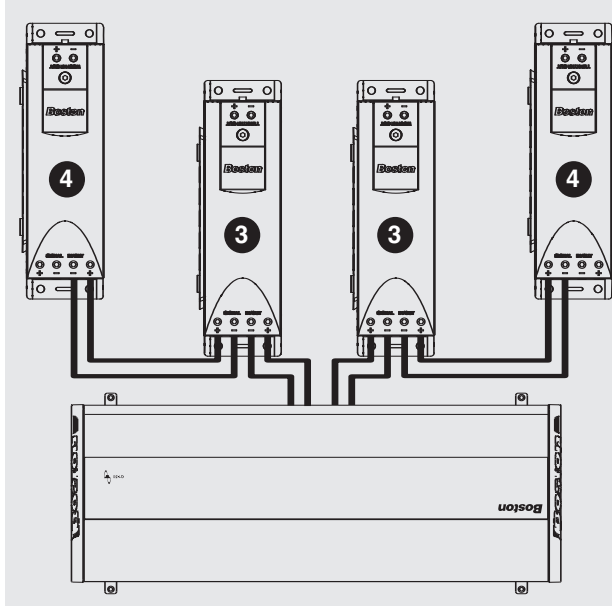

Crossover - All Connected

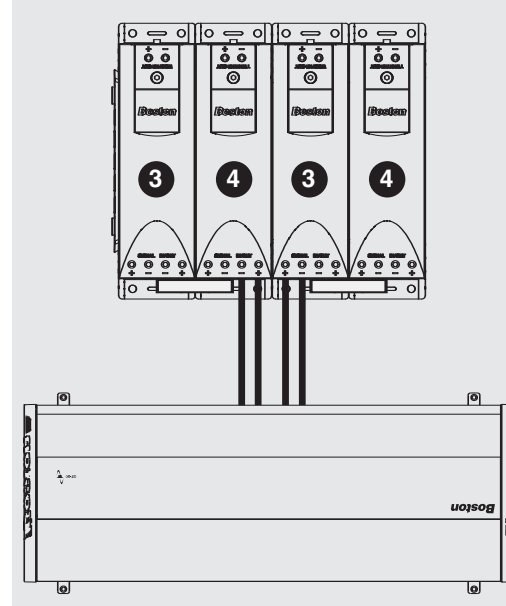

Crossover - Connection

